

COLORADO LURE COURSING ASSOCIATION

Darci Kunard
17531 E 104th Place
Reunion, CO 80022
kdarci@yahoo.com

LET'S GET OUR 47TH GRAND NATIONAL ON!!

After a confusing and difficult 2020, this year we celebrate getting back to a new normal or as we like to call it:

2021 ABBY-NORMAL GRAND NATIONAL

Again this year, thanks to a generous donation, there will be cash prizes awarded on Sunday after the Best in Event:

CASH PRIZES FOR BEST IN EVENT!

1st Place \$200
2nd Place \$75
3rd Place \$25

You will see the return of the big tent, Saturday Night Dinner on the field and our fabulous Raffle

One thing you can always count on is being wowed throughout the weekend by some of the finest coursing hounds in the country navigating their way around challenging courses.

JOIN US FOR THE FUN!

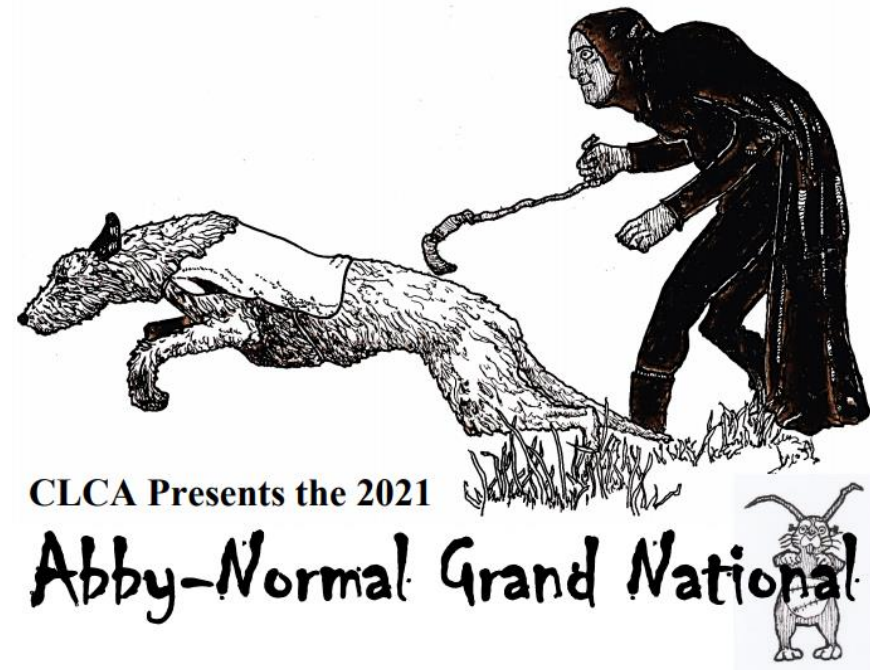

Thank you, Mike Hussey, for this logo!

CLCA Presents the 47th Abby-Normal Grand National

September 17, 18 and 19, 2021

PLEASE READ VERY CAREFULLY.

This year we are again in Southern Colorado and the Pikes Peak region, with its wide open spaces and staggering views. The terrain at the trial site is grassy with very sparse overgrazed vegetation, there are no rocks and some cactus. The surface is coarse sand and drains well. As this is private property we strongly recommend that vehicles proceed very slowly entering or leaving the trial site. The altitude is over 7000 feet. We do not expect this to affect either the general health or the athletic ability of your hounds but people with respiratory or cardiac problems should seek medical advice before exerting themselves at this altitude.

FRIDAY, September 17, 2021, SATURDAY, September 18, 2021 & SUNDAY, September 19, 2021

The COLORADO LURE COURSING ASSOCIATION will hold ASFA Sanctioned All-Breed Lure Field Trial all three days at the same location.

ELIGIBILITY TO COMPETE IN CLCA'S GRAND NATIONAL BEST-IN-EVENT

The requirements needed to qualify to compete in the Grand National Best in Event run which will take place on Sunday, September 19th after the regular trial are as follows:

- Winner of Best of Breed, Friday, Saturday or Sunday.
- Compete in two of the three ASFA Trials, Sunday being mandatory
- Any hound that is DISMISSED or DISQUALIFIED at the Sunday trial will NOT be eligible to compete in the Best-in-Event.
- All hounds are required to run a BEST OF BREED run on Sunday, whether it is forfeited, the only hound qualifying, or only one in that particular breed.

The Grand National Best-in-Event is NOT an ASFA sanctioned event.

OBJECTIVE

The objective of the GRAND NATIONAL is to bring together the finest lure coursing sighthounds from the continent and to provide for them a challenging test of their relative abilities on a demanding and extended series of courses. The emphasis will again be on the individual breeds with each Best of Breed winner running approximately two miles during the two-day period to earn this title. In order to match various breeds against each other in competition, there will also be a Best-in-Event run-off approximately one mile, depending upon field conditions.

JUDGES

Because of the unusual difficulty of the courses caused by distance and terrain as well as the anticipated quality of the dogs running, all trials will use two judges except for the Best-in-Event on Sunday, when more may be used and be selected from the panel of judges from Friday, Saturday and Sunday.

TRIAL PROCEDURES

The ASFA sanctioned field trial on Friday will consist of a course of 755 yards reversed for finals, Saturday's course of 760 yards reversed for finals. Sunday's course will consist of Field "A" of 875 yards and Field "B" of 800 yards, with the preliminary run on Field 1 and the finals on Field 2. Best of Breed runs may be run on either of the course plans. Field "A" and "B" will be joined together for the BEST-IN-EVENT run, which is a NON ASFA event. In order to compete in the 2021 Grand National Best-in-Event run on Sunday, the hounds have to be Best of Breed winners and have competed in two of the three ASFA trials, Sunday being mandatory. No hound will be allowed to compete who fails to receive a minimum of 200 points. All hounds must run a Best of Breed course in order to advance to the Best-in-Event, even if there is only one qualifying hound, or one stake in the breed. This applies to the Sunday trial only. The Best of Breed winners who have met these requirements will be advanced to the 2021 Grand National Best-in-Event competition, which will consist of one course of approximately one mile in length, depending upon course conditions. Any hound that is DISMISSED or DISQUALIFIED during the Sunday Trial will NOT be eligible to compete in the Best of Event Run. Any hound entered only in the Single Stake that wins high single in trial on Friday, Saturday or Sunday and competes in two of the three days with Sunday being mandatory, may compete for Best Single in Event. This will be run on the Best in Event Field and will be judged before the running of the Best in Event.

TROPHIES AND ROSETTES

Ribbons suitably inscribed will be awarded for all placements on Friday, Saturday and Sunday. Trophies will be awarded for Best of Breed on Friday, Saturday and Sunday. The Best-in-Event winner will receive a trophy, along with a Humane Purse to be donated to a recognized canine humane society or research facility, subject to approval by the COLORADO LURE COURSING ASSOCIATION Board of Directors. Donations to the Humane Purse gladly accepted, see separate insert in the premium list. The CLCA is also offering a perpetual trophy for Best-in-Event consisting of a silver plated wine cooler on a walnut base engraved with the names of the Best-in-Field winners, to be retained by the Colorado Lure Coursing Association.

ACCOMMODATIONS - EARLY RESERVATIONS ARE A MUST

The following will accept guests with well behaved dogs, and are in the Colorado Springs area:

Travel Lodge, Space Village Ave, 719-596-5588

Super 8 Colorado Springs, 719-597-4100

LaQuinta, Garden of the Gods, 719-528-5060

Motel 6, 3228 N. Chestnut – 719-520-5400 (20 miles from site)

Camping is available at the site \$15.00 a day. Must be self-contained.

Falcon Meadow Campgrounds, 11150 Hwy 24, Falcon – 719-495-2694

(Falcon is 5 miles west of the trial site)

AIRLINE RESERVATIONS

DENVER INTERNATIONAL AIRPORT (DIA) in Denver, or the COLORADO SPRINGS AIRPORT.

Flights daily from most major cities on major Airlines.

GENERAL INFORMATION

Bring plenty of water for your dogs. It is advised that all hounds entered be in top physical condition for this trial since the altitude of over 7000 feet can sometimes affect their performance.

First time entered hounds must have met certification requirements.

CLOTHING should be informal and a variety is advised as Colorado temperatures and weather can be unpredictable.

CATALOG ADVERTISING

Advertising Deadline is Friday, September 3, 2021. It must be camera-ready. Checks MUST accompany your ads, and made payable to CLCA.

Prices:

Full Page	\$25 commercial	\$20 private
Half Page	\$15 commercial	\$10 private
Quarter Page	\$10 commercial	\$5 private
Inside Front or Back Cover	\$50 commercial	\$25 private
Photos	\$10 extra.	

Send to: Deann Britton, rahwynd@yahoo.com, P O Box 440847, Aurora, CO 80044-0847, 303-249-2844.

COLORADO LURE COURSING ASSOCIATION

Darci Kunard, Field Trial Secretary

17531 E 104th Place

Reunion, CO 80022

kdarci@yahoo.com

720-938-3303

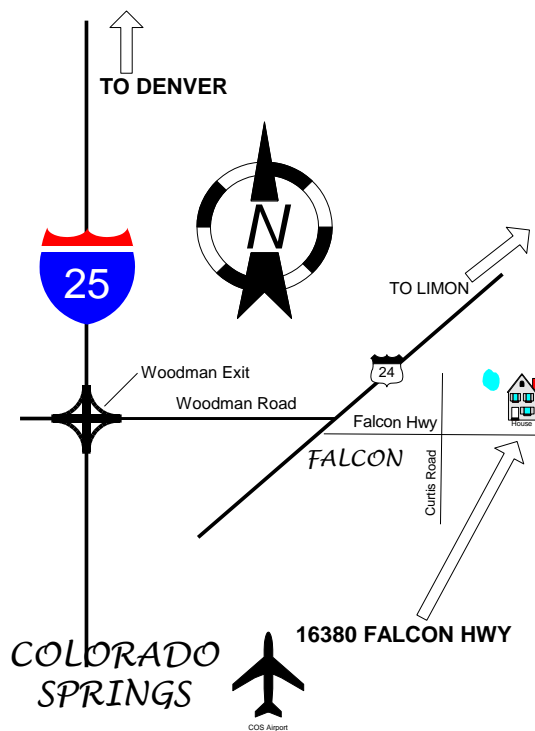

From I-25 North or South: Take Woodmen Road Exit and travel east to Highway 24. Turn Right on Highway 24 and then turn Left on Meridian. Go to stop sign and then Turn Left on Falcon Highway. Turn Left in drive way at 16380 Falcon Highway.

PREMIUM LIST

EARLY ENTRIES close on Friday, September 3, 2021 at 6:00 P.M.

NO DAY OF TRIAL ENTRIES

(Substitutions for lame hounds or bitches in season will be allowed prior to 7:30 A.M. on the day of the trial. Owner of the substituted hound must be the Same as the hound already entered.)

REGION 3 ASFA SANCTIONED ALL BREED LURE FIELD TRIAL



COLORADO LURE COURSING ASSOCIATION

47th Abby-Normal GRAND NATIONAL

FRIDAY, SEPTEMBER 17, 2021
SATURDAY, SEPTEMBER 18, 2021
SUNDAY, SEPTEMBER 19, 2021



FALCON INSTITUTE FOR ADVANCED COURSING STUDIES
16380 FALCON HIGHWAY
PEYTON, COLORADO 80831-7993

EARLY ENTRY FEES: \$22.00 for first; \$19.00 each additional hound
With same owner.

Breeder, Kennel & Bench: \$10.00 a unit.
NO DAY OF TRIAL ENTRIES

Permission has been granted by the American Sighthound Field Association for the holding of this event under American Sighthound Field Association Rules and Regulations

Audrey Silverstein, Chairman
ASFA Scheduling Committee

COLORADO LURE COURSING ASSOCIATION

OFFICERS AND DIRECTORS

President	Darci Kunard
Vice President	Connie Sullivan
Recording Secretary	Robin Phinney
Corresponding Secretary	Dan Heidel
Treasurer	Deann Britton
Directors-at-Large:	Danielle Collins Heather Fletcher Mike Hussey Cathy Day Gina Hayden Peter Lowe

JUDGES (AND THEIR ASSIGNMENTS)

Frank Cassano, LaSalle, CO
 Mike Hussey, Elizabeth, CO
 Kent Standerford, Omaha, NE
 S = Single, * = Provisional

Friday 9/17/2021

JUDGE	A	Az	Ba	B	C	G	Ib	Iw	IG	P	R	S	SD	SI	SW	W	Sgl	Pvl
Mike									X	X	X	X	X	X	X		X	X
Claudia	X	X	X	X	X	X	X	X						X	X	X	X	X
Kent	X	X	X	X	X	X	X	X	X	X	X	X	X			X		

Saturday 9/18/2021

JUDGE	A	Az	Ba	B	C	G	Ib	Iw	IG	P	R	S	SD	SI	SW	W	Sgl	Pvl
Dan								X								X	X	X
Mike	X	X	X	X	X	X	X	X	X	X	X	X	X	X	X	X	X	X
Kent	X	X	X	X	X	X	X	X	X	X	X	X	X	X	X			

Sunday 9/19/2021

JUDGE	A	Az	Ba	B	C	G	Ib	Iw	IG	P	R	S	SD	SI	SW	W	Sgl	Pvl
Frank	X	X	X	X	X	X	X	X	X	X	X	X	X	X	X	X	X	X
Dan					X	X	X	X	X	X	X	X	X	X	X	X	X	X
Kent	X	X	X	X														

FIELD COMMITTEE

Field Chairmen Deann Britton rahwynd@yahoo.com and
 Connie Sullivan cesullivan@comcast.net
Field Secretary Darci Kunard kdarci@yahoo.com 17531 E 104th Place, Reunion, CO 80022
 720-938-3303

Lure Operators T Golcher, D Heidel, K Standerford, C Sullivan,
Field Clerk M Bisbee, H Fletcher,
Inspection M Bisbee, H Fletcher, R Phinney, KC Thompson
Huntmaster D. Britton, C. Scott, C. Sullivan, KC Thompson

Ribbons or rosettes will be offered for all placements.
 First=Blue, Second=Red, Third=Yellow, Fourth=White, NBQ=Green
 Highest Scoring Single=Navy/Gold, Breeder= Rose, Kennel= Green
 Best of Breed=Purple/Gold, & Best in Event=Red, White & Blue.

TRIAL HOURS: 7:00 a.m. UNTIL COMPLETED. NO Day of Trial Entries.
ROLL CALL: PROMPTLY AT 8:00 A.M. DRAW: 8:30 A.M.
 Any hound not present at Roll Call will be scratched and entry fee will not be refunded.

ELIGIBLE BREEDS & REGISTRY

Only purebred Afghan Hounds, Azawakhs, Basenjis, Borzoi, Cirneco dell'Etna, Greyhounds, Ibizan Hounds, Irish Wolfhounds, Italian Greyhounds, Pharaoh Hounds, Rhodesian Ridgebacks, Salukis, Scottish Deerhounds, Silken Windhound, Sloughis and Whippets may be entered in the regular stakes. Provisional breeds may be entered in the Provisional Stake or the Singles Stake. Provisional currently include purebred Chart Polski, Galgo Español, Magyar Agar,

Peruvian Inca Orchid, Portuguese Podengo (Pequeno), Portuguese Podengo (Medio & Grande), and must be individually registered with the appropriate registry.
 All entries shall be individually registered with the AKC (including ILP & PAL), the NGA, the UKC, the FCI, an ASFA-recognized foreign or ASFA Board approved registry, or possess a CRN from the SPDBS. A photocopy of acceptable registry must be submitted with each hound's first ASFA field trial entry; this requirement is waived for hounds registered with the NGA.

ENTRIES WILL NOT BE ACKNOWLEDGED BY MAIL OR TELEPHONE. LATE, INCOMPLETE, UNSIGNED OR CONDITIONAL ENTRIES WILL NOT BE ACCEPTED.

STAKES OFFERED:

OPEN - Any eligible sighthound, excluding ASFA Field Champions of record that has met ASFA Certification requirements.

FIELD CHAMPION - Any ASFA Field Champion

VETERAN : Any eligible hound whose age is at least six years, except Irish Wolfhounds whose age shall be at least five years, and Afghan Hounds, Rhodesian Ridgebacks, Salukis, and Whippets whose age shall be at least seven years. Points go toward V-Fch or V-LCM titles."

SINGLE STAKE: Any eligible sighthound including those disqualified to run in other stakes. Each hound runs alone. Not eligible for Best of Breed or Best in Field. Hounds are eligible to earn TCP and CPX titles from the Singles stake. Provisional breeds are not eligible for these titles.

PROVISIONAL - Any eligible sighthound of an eligible Provisional stake that has met certification requirements.

BREEDER: For any breed which shall have, designated at the time of entry, two hounds bred by the same person or individual.

KENNEL: For hounds of any individual breed, an entry shall consist of two hounds designated at the time of entry in one of the regular stakes, being owned and kenneled by the same person or individual.

BENCH: For any eligible sighthound with proof on file with the ASFA of a conformation champion title from the AKC, CKC or both, or a conformation grand champion title from the UKC.

NO BEST IN FIELD WILL BE OFFERED. BEST IN EVENT ON SUNDAY

GENERAL INFORMATION

Conditions of Entry: All entries must be one year or older on the day of the trial. Stakes will be split into flights by public random draw if the entry in any regular stake is 20 or more. Bitches in season, lame hounds and hounds with breed disqualifications will be excused at roll call. Spayed, neutered, monorchid or cryptorchid hounds without breed disqualifications may be entered; hounds with breed disqualifications are not eligible to enter except in the Single Stake. Hounds not present at the time of roll call will be scratched. All hounds will run twice, in trios if possible or braces (except in the Single Stake), unless excused, dismissed or disqualified.
Hound certification runs will be offered on Friday ONLY and after the trial.

EQUIPMENT: Type of lure machine: battery-powered continuous-loop system. Back-up equipment will be available. Type of lures: highly-visible plastic strips.

A \$20.00 fee will be assessed for any returned checks. Persons exhibiting conduct detrimental to ASFA/CLCA/ any hound(s)/other person(s) will be asked to leave the trial site.

There will be a \$5.00 fine for any owner who does not clean up after his/her hound.
 A penalty of \$5.00 will be assessed for any loose hound not competing in the course in progress.

INFORMATION/POLICIES

- Port-a-pottis on site.
- BRING WATER AND SHADE FOR YOUR HOUNDS.
- Veterinarian – **Friday and Saturday** – Ponderosa Veterinary Clinic 6770 Foxtrot Lane Suit B 719-433-7671.
Sunday: Powers Pet Emergency & Specialty, 5888 Tutt Blvd. 719-473-0482
- Due to dry conditions, smoking of any kind is prohibited on the field, Absolutely NO CAMP FIRES!
- PICK UP AFTER YOUR DOG AND YOURSELF!
- For further information contact either: Connie Sullivan at 303-690-1677, cesullivan@comcast.net or Deann Britton at 303-249-2488, Rahwynd@yahoo.com or Darci Kunard, kdarci@yahoo.com 720-938-3303

COURSE PLANS:

Colorado Lure Coursing Association reserves the right to alter the course design(s) depending on field and/or weather conditions on the day of the trial.

Friday, 9/17/2021

755 yards, Prelims clockwise and reversed for the finals

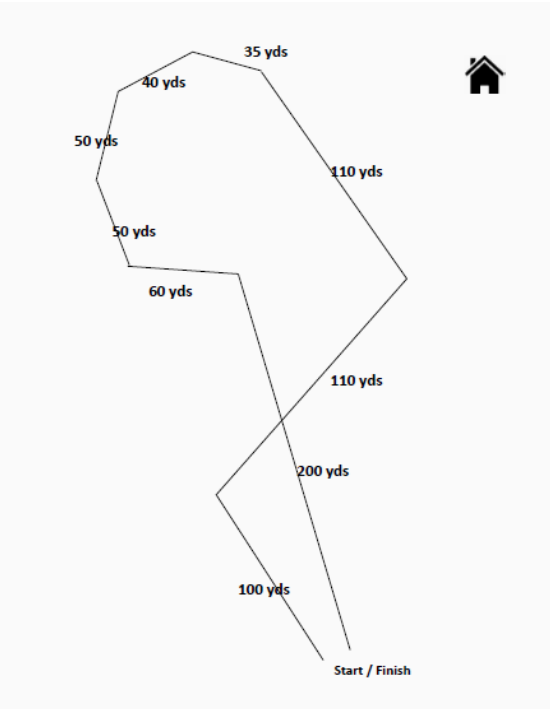

755 yards



Sunday, 9/20/21

Field A, 875 yards, Prelims Counter clock-wise.

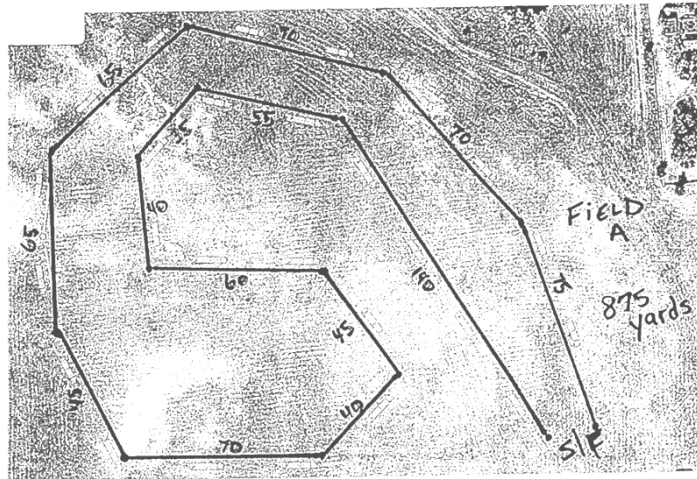

Field B, 800 yards, Finals counter clock-wise.

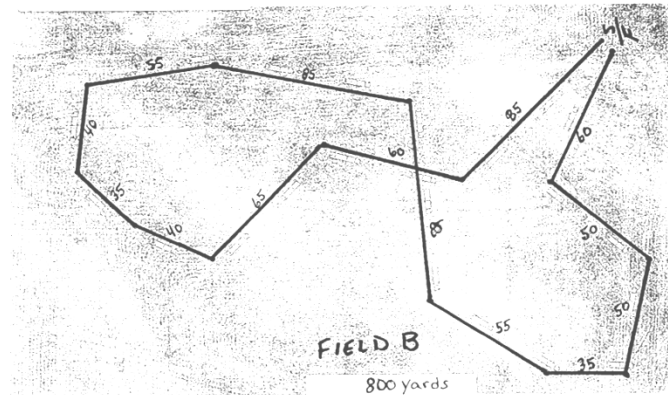

Saturday 9/18/2021

760 yards, Prelims clockwise reversed for finals

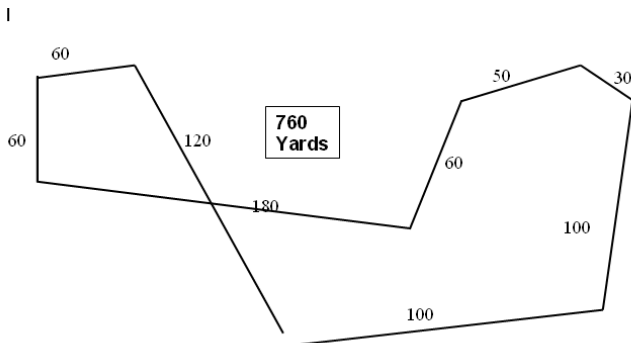

Warning: It is advised that all hounds entered be in top physical condition due to the altitude and rigorous conditions of the course, which will be run on natural terrain and may include such hazards as rocks, trees, cactus, vegetation, gopher holes, gullies, bodies of water and other obstacles. ALL HOUNDS RUN AT THE OWNER'S SOLE RISK.

SATURDAY NIGHT DINNER

CLCA Lure Coursing Procedures

We will follow the State of Colorado and all local guidelines.

As of 5/23/2021 the number of people at an outdoor gathering is **NOT limited** this may change, and we will adjust accordingly. Further, El Paso County does **NOT** require face-coverings outdoors. Therefore, face-coverings are optional – up to the individual's comfort level. Please continue to maintain social distancing measures and respect the space that others request.

1. **All participants shall maintain the 6-foot social distancing requirement when interacting with people not in their household.**
2. No food will be served. Please bring your own food, water and shade for yourself and your dogs. None will be available.
3. Park at a 4 to 6-foot distance away from other vehicles.
4. Roll Call will be done at a central location. We will ask the owners of females to wipe their dogs and show the inspection committee the tissue.
5. Huntmasters will stand 4 to 6 feet from the dogs after inspecting blankets and slip leads.
6. At the starting line, all dogs will stand 3-4 feet apart.
7. Practice social distancing the best you can and respect the space that others request.
8. Please be aware of the running order posted.

Above all, have fun with your dogs and be safe!!!



MENU:

BRISKET
PULLED PORK
CHICKEN
WESTERN BEANS
COLESLAW
GREEN BEANS & BACON
BUNS
(BEER, WINE AND SODA PROVIDED BY CLCA)

\$18.00 PER PLATE
PLEASE INCLUDE NUMBER OF DINNERS ON
MONEY BREAK DOWN SHEET

EMAIL ENTRIES TO:

kdarci@yahoo.com

ENTRIES THAT

ARE EMAILED MUST BE ACCOMPANIED BY PAYMENT

THRU OUR PayPal account at:

deann.clcatreasurer@gmail.com . Please add \$1.00 per
hound per day entered. If the original entries along with
payment are not received the emailed entries will NOT
constitute a valid entry.

CHECK OUT THE CLCA RAFFLE
CALL OR EMAIL CATHY DAY FOR DONATIONS

303-257-0444

georun@worldnet.att.net



**2021 GRAND NATIONAL T-SHIRT
SPECIALTY DESIGNED IMPRINTED SPORTSWEAR**

47th Grand National

PRE-ORDERS MUST BE RECEIVED BY September 4rd, 2021
(See money breakdown sheet enclosed)

PRE-ORDERS ASSURE SIZES

SIZES: Medium Large Extra large XXL

T-SHIRTS: Pre-Orders - \$19.00, day of trial \$25.00.
(add additional \$3.00 for XXL or larger)

VENDOR BOOTHS

*CLCA encourages you to display your artwork and coursing
wares at the Grand National, for which there will be a charge of
\$10.00 per table. (See Money breakdown sheet)*

**PLEASE NOTE THAT THERE WILL BE
NO FOOD VENDORS.
PLEASE PROVIDE YOUR OWN
SNACKS,
LUNCH AND DRINKS.**

**Grand National
Money Break Down Sheet**
Name: _____

Friday Entry Fee	\$22.00 st dog	\$
	\$19.00 each add'l \$10.00 /unit kennel, breeder or bench	\$
Saturday Entry Fee	\$22.00 1 st dog	\$
	\$19.00 each add'l \$10.00 /unit kennel, breeder or bench	\$
Sunday Entry Fee	\$22.00 1 st dog	\$
	\$19.00 each add'l \$10.00 /unit kennel, breeder or bench	\$
Dog's Name	Number of Grand Nationals:	
T-Shirt Regular \$19 Plus \$3 for XXL	Size _____	\$
Saturday Dinner \$18.00 each	# of people _____	\$
Humane Purse		\$
Name as it is to appear in Catalog For Humane Purse Donation:		
Trophy Donation		\$
Name as it is to appear in Catalog For Trophy Donation:		
Camping fees	\$15 X _____ nights	\$
Vendor Booth	\$10 per table	
Total		\$

Please
Donate
to the
HUMANE PURSE
Say thanks to your hound.
Give for the health of it.

*Make check payable to CLCA, in honor of your favorite hound
(see money breakdown sheet enclosed).*

*The Humane Purse will be presented to an approved humane or research
facility for example the Morris Animal Foundation, in the name of the
owner of the*

2021 Grand National Best-in-Event Winner.

*"Lure coursing should benefit the hounds that provide us with the enjoyment
of the sport....."*



**OFFICIAL AMERICAN SIGHTHOUND FIELD ASSOCIATION ENTRY FORM
COLORADO LURE COURSING ASSOCIATION**

47TH Grand National Friday, September 17th, 2021

Entry Fees: \$22.00 1st dog, \$19.00 each add'l, \$10.00/unit: Breeder/Kennel/Bench, US Funds only

NO Day of Trial Entries.

Early Entries close 5:00pm, September 3rd, 2021

Mail entries: Darci Kunard, 17531 E. 104th Place, Reunion, CO 80022

Email entries: kdarci@yahoo.com PayPal: deann.clatreasurer@gmail.com

Fee Paid _____ The Field Secretary cannot accept conditional, unsigned, incomplete or unpaid entries; please check your completed entry carefully.

Breed:		Call Name:	
Registered Name of Hound:			
Stake: <input type="checkbox"/> Open <input type="checkbox"/> FCH <input type="checkbox"/> Veteran <input type="checkbox"/> Single <input type="checkbox"/> Provisional		Additional Stakes <input type="checkbox"/> Kennel <input type="checkbox"/> Breeder <input type="checkbox"/> Bench	
Registration Number: (please write in registering body before number)			
<input type="checkbox"/> If possible, please separate my hounds	Date of Birth:	Sex: <input type="checkbox"/> Dog <input type="checkbox"/> Bitch	
Name of actual owner(s):			
Address:		Phone:	
City:		State:	Zip:
E-mail (Optional)		(Optional) Region of Residence:	
Emergency Contact Name and Phone (Optional)			
<input type="checkbox"/> Check if this is the first ASFA trial for this hound. Attach a Hound Certification or waiver if entered in Open, Veterans, Limited.			
<input type="checkbox"/> Check if this is a first-time entry, a copy of the official Registration of this hound must accompany this entry unless NGA.			
<input type="checkbox"/> Check if any information has changed since the last ASFA trial entry. Regarding _____			
<input type="checkbox"/> Check if this hound has been dismissed within the last 6 trials entered. Must be marked in order to qualify for a "clean" trial requirement.			

I CERTIFY that I am the actual owner of this dog, or that I am the duly authorized agent of the actual owner whose name I have entered above. In consideration of the acceptance of this entry and the opportunity to have this dog judged and to win prize money, ribbons, or trophies, I (we) agree to abide by the rules and regulations of the American Sighthound Field Association in effect at the time of this lure field trial, and by any additional rules and regulations appearing in the premium list for this lure field trial. I (we) agree that the club holding this lure field trial has the right to refuse this entry for cause, which the club shall deem to be sufficient. I (we) agree to hold this club, its members, directors, governors, officers, agents or other functionaries, any employees of the aforementioned parties and the owner(s) of the trial premises or grounds harmless from any claim for loss or injury which may be alleged to have been caused directly or indirectly to any person or thing by the act of this dog while in or upon the lure field trial premises or grounds or near any entrance thereto and I (we) personally assume all responsibility and liability for any such claim, and I (we) further agree to hold the aforementioned parties harmless from any claim loss of this dog by disappearance, theft damage or injury be caused or alleged to be caused by the negligence of the club or any of the aforementioned parties or by the negligence of any person or any other cause or causes. I (we) certify and represent that the dog entered is not a hazard to person or other dogs. This entry is submitted for acceptance of the forgoing representations and agreements.

SIGNATURE of owner or his agent
duly authorized to make this entry _____

Please separate entries before submitting to FTS

**OFFICIAL AMERICAN SIGHTHOUND FIELD ASSOCIATION ENTRY FORM
COLORADO LURE COURSING ASSOCIATION**

47TH Grand National Friday, September 17th, 2021

Entry Fees: \$22.00 1st dog, \$19.00 each add'l, \$10.00/unit: Breeder/Kennel/Bench, US Funds only

NO Day of Trial Entries.

Early Entries close 5:00pm, September 3rd, 2021

Mail entries: Darci Kunard, 17531 E. 104th Place, Reunion, CO 80022

Email entries: kdarci@yahoo.com PayPal: deann.clatreasurer@gmail.com

Fee Paid _____ The Field Secretary cannot accept conditional, unsigned, incomplete or unpaid entries; please check your completed entry carefully.

Breed:		Call Name:	
Registered Name of Hound:			
Stake: <input type="checkbox"/> Open <input type="checkbox"/> FCH <input type="checkbox"/> Veteran <input type="checkbox"/> Single <input type="checkbox"/> Provisional		Additional Stakes <input type="checkbox"/> Kennel <input type="checkbox"/> Breeder <input type="checkbox"/> Bench	
Registration Number: (please write in registering body before number)			
<input type="checkbox"/> If possible, please separate my hounds	Date of Birth:	Sex: <input type="checkbox"/> Dog <input type="checkbox"/> Bitch	
Name of actual owner(s):			
Address:		Phone:	
City:		State:	Zip:
E-mail (Optional)		(Optional) Region of Residence:	
Emergency Contact Name and Phone (Optional)			
<input type="checkbox"/> Check if this is the first ASFA trial for this hound. Attach a Hound Certification or waiver if entered in Open, Veterans, Limited.			
<input type="checkbox"/> Check if this is a first-time entry, a copy of the official Registration of this hound must accompany this entry unless NGA.			
<input type="checkbox"/> Check if any information has changed since the last ASFA trial entry. Regarding _____			
<input type="checkbox"/> Check if this hound has been dismissed within the last 6 trials entered. Must be marked in order to qualify for a "clean" trial requirement.			

I CERTIFY that I am the actual owner of this dog, or that I am the duly authorized agent of the actual owner whose name I have entered above. In consideration of the acceptance of this entry and the opportunity to have this dog judged and to win prize money, ribbons, or trophies, I (we) agree to abide by the rules and regulations of the American Sighthound Field Association in effect at the time of this lure field trial, and by any additional rules and regulations appearing in the premium list for this lure field trial. I (we) agree that the club holding this lure field trial has the right to refuse this entry for cause, which the club shall deem to be sufficient. I (we) agree to hold this club, its members, directors, governors, officers, agents or other functionaries, any employees of the aforementioned parties and the owner(s) of the trial premises or grounds harmless from any claim for loss or injury which may be alleged to have been caused directly or indirectly to any person or thing by the act of this dog while in or upon the lure field trial premises or grounds or near any entrance thereto and I (we) personally assume all responsibility and liability for any such claim, and I (we) further agree to hold the aforementioned parties harmless from any claim loss of this dog by disappearance, theft damage or injury be caused or alleged to be caused by the negligence of the club or any of the aforementioned parties or by the negligence of any person or any other cause or causes. I (we) certify and represent that the dog entered is not a hazard to person or other dogs. This entry is submitted for acceptance of the forgoing representations and agreements.

SIGNATURE of owner or his agent
duly authorized to make this entry _____

Please separate entries before submitting to FTS

**OFFICIAL AMERICAN SIGHTHOUND FIELD ASSOCIATION ENTRY FORM
COLORADO LURE COURSING ASSOCIATION**

47th Grand National Saturday, September 18th, 2021

Entry Fees: \$22.00 1st dog, \$19.00 each add'l, \$10.00/unit: Breeder/Kennel/Bench, US Funds only

NO Day of Trial Entries.

Early Entries close 5:00pm, September 3rd, 2021

Mail entries: Darci Kunard, 17531 E. 104th Place, Reunion, CO 80022

Email entries: kdarci@yahoo.com PayPal: deann.clatreasurer@gmail.com

Fee Paid _____ The Field Secretary cannot accept conditional, unsigned, incomplete or unpaid entries; please check your completed entry carefully.

Breed:		Call Name:	
Registered Name of Hound:			
Stake: <input type="checkbox"/> Open <input type="checkbox"/> FCH <input type="checkbox"/> Veteran <input type="checkbox"/> Single <input type="checkbox"/> Provisional		Additional Stakes <input type="checkbox"/> Kennel <input type="checkbox"/> Breeder <input type="checkbox"/> Bench	
Registration Number: (please write in registering body before number)			
<input type="checkbox"/> If possible, please separate my hounds	Date of Birth:	Sex: <input type="checkbox"/> Dog <input type="checkbox"/> Bitch	
Name of actual owner(s):			
Address:		Phone:	
City:	State:	Zip:	
E-mail (Optional)		(Optional) Region of Residence:	
Emergency Contact Name and Phone (Optional)			
<input type="checkbox"/> Check if this is the first ASFA trial for this hound. Attach a Hound Certification or waiver if entered in Open, Veterans, Limited.			
<input type="checkbox"/> Check if this is a first-time entry, a copy of the official Registration of this hound must accompany this entry unless NGA.			
<input type="checkbox"/> Check if any information has changed since the last ASFA trial entry. Regarding _____			
<input type="checkbox"/> Check if this hound has been dismissed within the last 6 trials entered. Must be marked in order to qualify for a "clean" trial requirement.			

I CERTIFY that I am the actual owner of this dog, or that I am the duly authorized agent of the actual owner whose name I have entered above. In consideration of the acceptance of this entry and the opportunity to have this dog judged and to win prize money, ribbons, or trophies, I (we) agree to abide by the rules and regulations of the American Sighthound Field Association in effect at the time of this lure field trial, and by any additional rules and regulations appearing in the premium list for this lure field trial. I (we) agree that the club holding this lure field trial has the right to refuse this entry for cause, which the club shall deem to be sufficient. I (we) agree to hold this club, its members, directors, governors, officers, agents or other functionaries, any employees of the aforementioned parties and the owner(s) of the trial premises or grounds harmless from any claim for loss or injury which may be alleged to have been caused directly or indirectly to any person or thing by the act of this dog while in or upon the lure field trial premises or grounds or near any entrance thereto and I (we) personally assume all responsibility and liability for any such claim, and I (we) further agree to hold the aforementioned parties harmless from any claim loss of this dog by disappearance, theft damage or injury be caused or alleged to be caused by the negligence of the club or any of the aforementioned parties or by the negligence of any person or any other cause or causes. I (we) certify and represent that the dog entered is not a hazard to person or other dogs. This entry is submitted for acceptance of the forgoing representations and agreements.

SIGNATURE of owner or his agent
duly authorized to make this entry _____

Please separate entries before submitting to FTS

**OFFICIAL AMERICAN SIGHTHOUND FIELD ASSOCIATION ENTRY FORM
COLORADO LURE COURSING ASSOCIATION**

47th Grand National Saturday, September 18th, 2021

Entry Fees: \$22.00 1st dog, \$19.00 each add'l, \$10.00/unit: Breeder/Kennel/Bench, US Funds only

NO Day of Trial Entries.

Early Entries close 5:00pm, September 3rd, 2021

Mail entries: Darci Kunard, 17531 E. 104th Place, Reunion, CO 80022

Email entries: kdarci@yahoo.com PayPal: deann.clatreasurer@gmail.com

Fee Paid _____ The Field Secretary cannot accept conditional, unsigned, incomplete or unpaid entries; please check your completed entry carefully.

Breed:		Call Name:	
Registered Name of Hound:			
Stake: <input type="checkbox"/> Open <input type="checkbox"/> FCH <input type="checkbox"/> Veteran <input type="checkbox"/> Single <input type="checkbox"/> Provisional		Additional Stakes <input type="checkbox"/> Kennel <input type="checkbox"/> Breeder <input type="checkbox"/> Bench	
Registration Number: (please write in registering body before number)			
<input type="checkbox"/> If possible, please separate my hounds	Date of Birth:	Sex: <input type="checkbox"/> Dog <input type="checkbox"/> Bitch	
Name of actual owner(s):			
Address:		Phone:	
City:	State:	Zip:	
E-mail (Optional)		(Optional) Region of Residence:	
Emergency Contact Name and Phone (Optional)			
<input type="checkbox"/> Check if this is the first ASFA trial for this hound. Attach a Hound Certification or waiver if entered in Open, Veterans, Limited.			
<input type="checkbox"/> Check if this is a first-time entry, a copy of the official Registration of this hound must accompany this entry unless NGA.			
<input type="checkbox"/> Check if any information has changed since the last ASFA trial entry. Regarding _____			
<input type="checkbox"/> Check if this hound has been dismissed within the last 6 trials entered. Must be marked in order to qualify for a "clean" trial requirement.			

I CERTIFY that I am the actual owner of this dog, or that I am the duly authorized agent of the actual owner whose name I have entered above. In consideration of the acceptance of this entry and the opportunity to have this dog judged and to win prize money, ribbons, or trophies, I (we) agree to abide by the rules and regulations of the American Sighthound Field Association in effect at the time of this lure field trial, and by any additional rules and regulations appearing in the premium list for this lure field trial. I (we) agree that the club holding this lure field trial has the right to refuse this entry for cause, which the club shall deem to be sufficient. I (we) agree to hold this club, its members, directors, governors, officers, agents or other functionaries, any employees of the aforementioned parties and the owner(s) of the trial premises or grounds harmless from any claim for loss or injury which may be alleged to have been caused directly or indirectly to any person or thing by the act of this dog while in or upon the lure field trial premises or grounds or near any entrance thereto and I (we) personally assume all responsibility and liability for any such claim, and I (we) further agree to hold the aforementioned parties harmless from any claim loss of this dog by disappearance, theft damage or injury be caused or alleged to be caused by the negligence of the club or any of the aforementioned parties or by the negligence of any person or any other cause or causes. I (we) certify and represent that the dog entered is not a hazard to person or other dogs. This entry is submitted for acceptance of the forgoing representations and agreements.

SIGNATURE of owner or his agent
duly authorized to make this entry _____

Please separate entries before submitting to FTS

**OFFICIAL AMERICAN SIGHTHOUND FIELD ASSOCIATION ENTRY FORM
COLORADO LURE COURSING ASSOCIATION**

47th Grand National Sunday, September 19th, 2021

Entry Fees: \$22.00 1st dog, \$19.00 each add'l, \$10.00/unit: Breeder/Kennel/Bench, US Funds only

NO Day of Trial Entries.

Early Entries close 5:00pm, September 3rd, 2021

Mail entries: Darci Kunard, 17531 E. 104th Place, Reunion, CO 80022

Email entries: kdarci@yahoo.com PayPal: deann.clatreasurer@gmail.com

Fee Paid _____ The Field Secretary cannot accept conditional, unsigned, incomplete or unpaid entries; please check your completed entry carefully.

Breed:		Call Name:	
Registered Name of Hound:			
Stake: <input type="checkbox"/> Open <input type="checkbox"/> FCH <input type="checkbox"/> Veteran <input type="checkbox"/> Single <input type="checkbox"/> Provisional		Additional Stakes <input type="checkbox"/> Kennel <input type="checkbox"/> Breeder <input type="checkbox"/> Bench	
Registration Number: (please write in registering body before number)			
<input type="checkbox"/> If possible, please separate my hounds	Date of Birth:	Sex: <input type="checkbox"/> Dog <input type="checkbox"/> Bitch	
Name of actual owner(s):			
Address:		Phone:	
City:	State:	Zip:	
E-mail (Optional)		(Optional) Region of Residence:	
Emergency Contact Name and Phone (Optional)			
<input type="checkbox"/> Check if this is the first ASFA trial for this hound. Attach a Hound Certification or waiver if entered in Open, Veterans, Limited.			
<input type="checkbox"/> Check if this is a first-time entry, a copy of the official Registration of this hound must accompany this entry unless NGA.			
<input type="checkbox"/> Check if any information has changed since the last ASFA trial entry. Regarding _____			
<input type="checkbox"/> Check if this hound has been dismissed within the last 6 trials entered. Must be marked in order to qualify for a "clean" trial requirement.			

I CERTIFY that I am the actual owner of this dog, or that I am the duly authorized agent of the actual owner whose name I have entered above. In consideration of the acceptance of this entry and the opportunity to have this dog judged and to win prize money, ribbons, or trophies, I (we) agree to abide by the rules and regulations of the American Sighthound Field Association in effect at the time of this lure field trial, and by any additional rules and regulations appearing in the premium list for this lure field trial. I (we) agree that the club holding this lure field trial has the right to refuse this entry for cause, which the club shall deem to be sufficient. I (we) agree to hold this club, its members, directors, governors, officers, agents or other functionaries, any employees of the aforementioned parties and the owner(s) of the trial premises or grounds harmless from any claim for loss or injury which may be alleged to have been caused directly or indirectly to any person or thing by the act of this dog while in or upon the lure field trial premises or grounds or near any entrance thereto and I (we) personally assume all responsibility and liability for any such claim, and I (we) further agree to hold the aforementioned parties harmless from any claim loss of this dog by disappearance, theft damage or injury be caused or alleged to be caused by the negligence of the club or any of the aforementioned parties or by the negligence of any person or any other cause or causes. I (we) certify and represent that the dog entered is not a hazard to person or other dogs. This entry is submitted for acceptance of the forgoing representations and agreements.

SIGNATURE of owner or his agent
duly authorized to make this entry _____

Please separate entries before submitting to FTS

**OFFICIAL AMERICAN SIGHTHOUND FIELD ASSOCIATION ENTRY FORM
COLORADO LURE COURSING ASSOCIATION**

47th Grand National Sunday, September 19th, 2021

Entry Fees: \$22.00 1st dog, \$19.00 each add'l, \$10.00/unit: Breeder/Kennel/Bench, US Funds only

NO Day of Trial Entries.

Early Entries close 5:00pm, September 3rd, 2021

Mail entries: Darci Kunard, 17531 E. 104th Place, Reunion, CO 80022

Email entries: kdarci@yahoo.com PayPal: deann.clatreasurer@gmail.com

Fee Paid _____ The Field Secretary cannot accept conditional, unsigned, incomplete or unpaid entries; please check your completed entry carefully.

Breed:		Call Name:	
Registered Name of Hound:			
Stake: <input type="checkbox"/> Open <input type="checkbox"/> FCH <input type="checkbox"/> Veteran <input type="checkbox"/> Single <input type="checkbox"/> Provisional		Additional Stakes <input type="checkbox"/> Kennel <input type="checkbox"/> Breeder <input type="checkbox"/> Bench	
Registration Number: (please write in registering body before number)			
<input type="checkbox"/> If possible, please separate my hounds	Date of Birth:	Sex: <input type="checkbox"/> Dog <input type="checkbox"/> Bitch	
Name of actual owner(s):			
Address:		Phone:	
City:	State:	Zip:	
E-mail (Optional)		(Optional) Region of Residence:	
Emergency Contact Name and Phone (Optional)			
<input type="checkbox"/> Check if this is the first ASFA trial for this hound. Attach a Hound Certification or waiver if entered in Open, Veterans, Limited.			
<input type="checkbox"/> Check if this is a first-time entry, a copy of the official Registration of this hound must accompany this entry unless NGA.			
<input type="checkbox"/> Check if any information has changed since the last ASFA trial entry. Regarding _____			
<input type="checkbox"/> Check if this hound has been dismissed within the last 6 trials entered. Must be marked in order to qualify for a "clean" trial requirement.			

I CERTIFY that I am the actual owner of this dog, or that I am the duly authorized agent of the actual owner whose name I have entered above. In consideration of the acceptance of this entry and the opportunity to have this dog judged and to win prize money, ribbons, or trophies, I (we) agree to abide by the rules and regulations of the American Sighthound Field Association in effect at the time of this lure field trial, and by any additional rules and regulations appearing in the premium list for this lure field trial. I (we) agree that the club holding this lure field trial has the right to refuse this entry for cause, which the club shall deem to be sufficient. I (we) agree to hold this club, its members, directors, governors, officers, agents or other functionaries, any employees of the aforementioned parties and the owner(s) of the trial premises or grounds harmless from any claim for loss or injury which may be alleged to have been caused directly or indirectly to any person or thing by the act of this dog while in or upon the lure field trial premises or grounds or near any entrance thereto and I (we) personally assume all responsibility and liability for any such claim, and I (we) further agree to hold the aforementioned parties harmless from any claim loss of this dog by disappearance, theft damage or injury be caused or alleged to be caused by the negligence of the club or any of the aforementioned parties or by the negligence of any person or any other cause or causes. I (we) certify and represent that the dog entered is not a hazard to person or other dogs. This entry is submitted for acceptance of the forgoing representations and agreements.

SIGNATURE of owner or his agent
duly authorized to make this entry _____

Please separate entries before submitting to FTS

**AMERICAN SIGHTHOUND FIELD ASSOCIATION
HOUND CERTIFICATION**

Rule effective October 1, 1994: Ch. V, Sec. 4 (a) OPEN STAKE: *To be eligible to enter the open stake, a hound must have been certified by a licensed judge within the year preceding the closing date for the entry or have previously competed in the Open Stake. This eligibility requirement also applies to a hound entered in the Limited or Veteran Stake, which has not competed in Open previously. Please complete this portion of this form and attach it to the entry form for the hound's first entry, including an entry for a Fun Trial.*

Registered Name of Hound: _____

Registration Number: _____ Breed: _____

Registered Owner's Name: _____

I hereby certify that on (date) _____, the above named hound completed a lure course of at least 500 yards, running with another hound of the same breed (or another breed with a similar running style). During the course the above named hound showed no inclination to interfere with the other hound. I further certify that I am a licensed judge for the ASFA.

Name of Licensed Judge: _____

Signature: _____ Date: _____

I hereby certify that the hound running in the certification course is the hound identified above and that information provided on this form is true and correct.

Signature: _____ Date: _____

Owner or Authorized Agent of Hound

This certification form must be attached to the entry form the first time this hound is entered in an open, limited, or veteran stake. Any hound entered in open, limited, or veteran (as a first time entered hound), which has not been certified, shall be declared ineligible by the records coordinator and shall forfeit any points and placements awarded.

PLEASE RETAIN A COPY FOR YOUR RECORDS.

**AMERICAN SIGHTHOUND FIELD ASSOCIATION
HOUND CERTIFICATION WAIVER**

Waiver of Requirement: *This requirement will be waived for a hound that has earned a lure coursing title from another recognized organization, if such title requires competition, and if a waiver for such title has been approved by the ASFA, or a CKC Hound Certification Form. If your hound qualifies for a waiver, complete this portion of this form and attach it to your entry form. Proof of waivers must accompany this certification form.*

Registered Name of Hound: _____

Registration Number: _____ Breed: _____

Registered Owner's Name: _____

CKC: FCH FCHX

AKC: QC SC FC

Hound Certification previously submitted.

I hereby certify that the hound identified above has completed the requirements for the title indicated above (or that the required Certification was previously submitted) and that the information provided on this form is true and correct.

Signature: _____ Date: _____

Owner or Authorized Agent of Hound

**AMERICAN SIGHTHOUND FIELD ASSOCIATION
HOUND CERTIFICATION**

Rule effective October 1, 1994: Ch. V, Sec. 4 (a) OPEN STAKE: *To be eligible to enter the open stake, a hound must have been certified by a licensed judge within the year preceding the closing date for the entry or have previously competed in the Open Stake. This eligibility requirement also applies to a hound entered in the Limited or Veteran Stake, which has not competed in Open previously. Please complete this portion of this form and attach it to the entry form for the hound's first entry, including an entry for a Fun Trial.*

Registered Name of Hound: _____

Registration Number: _____ Breed: _____

Registered Owner's Name: _____

I hereby certify that on (date) _____, the above named hound completed a lure course of at least 500 yards, running with another hound of the same breed (or another breed with a similar running style). During the course the above named hound showed no inclination to interfere with the other hound. I further certify that I am a licensed judge for the ASFA.

Name of Licensed Judge: _____

Signature: _____ Date: _____

I hereby certify that the hound running in the certification course is the hound identified above and that information provided on this form is true and correct.

Signature: _____ Date: _____

Owner or Authorized Agent of Hound

This certification form must be attached to the entry form the first time this hound is entered in an open, limited, or veteran stake. Any hound entered in open, limited, or veteran (as a first time entered hound), which has not been certified, shall be declared ineligible by the records coordinator and shall forfeit any points and placements awarded.

PLEASE RETAIN A COPY FOR YOUR RECORDS.

**AMERICAN SIGHTHOUND FIELD ASSOCIATION
HOUND CERTIFICATION WAIVER**

Waiver of Requirement: *This requirement will be waived for a hound that has earned a lure coursing title from another recognized organization, if such title requires competition, and if a waiver for such title has been approved by the ASFA, or a CKC Hound Certification Form. If your hound qualifies for a waiver, complete this portion of this form and attach it to your entry form. Proof of waivers must accompany this certification form.*

Registered Name of Hound: _____

Registration Number: _____ Breed: _____

Registered Owner's Name: _____

CKC: FCH FCHX

AKC: QC SC FC

Hound Certification previously submitted.

I hereby certify that the hound identified above has completed the requirements for the title indicated above (or that the required Certification was previously submitted) and that the information provided on this form is true and correct.

Signature: _____ Date: _____

Owner or Authorized Agent of Hound